

**H2**

Headset Helmet Intercom  
2-Rider Kit

User Manual

Thank you for choosing MOMAN product. Please read this manual carefully before use and follow all instructions mentioned herein.

## Caring For Your MOMAN Product

- Please keep the product in a dry, clean, dust-free environment.
- Keep corrosive chemicals, liquids and heat source away from the product to prevent mechanics damage.
- Use only a soft and dry cloth for cleaning the product.
- Malfunction may be caused by dropping, impact of external force.
- Do not attempt to disassemble the product. Doing so voids warranty.
- Please have the product checked or repaired by authorized technicians if any malfunctions happened.
- Failure to follow all the instructions may result in mechanics damage.
- Warranty does not apply to human errors.

## Package List

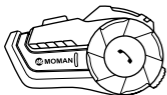

Intercom x2

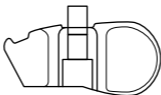

Velcro Clip x2

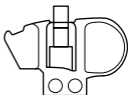

Back Clip x2



Hook and Loop  
Fasteners x2

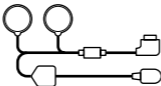

1 Pair of Speakers with  
Microphone x2



Manual x1

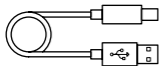

USB Cable x2



Screw Driver x2



Headphone Velcro x8

## Product Introduction

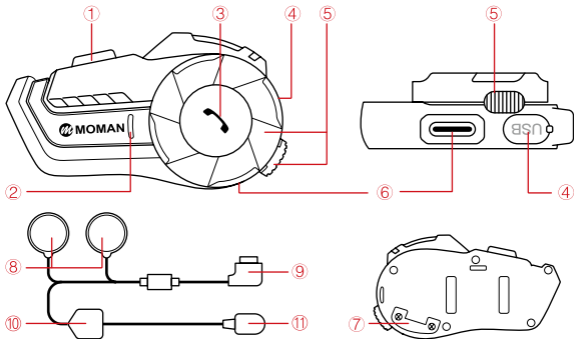

- |                   |                      |                |                     |
|-------------------|----------------------|----------------|---------------------|
| ① On/Off Key      | ④ Charging Interface | ⑦ Buckle Flap  | ⑩ Butterfly sticker |
| ② Indicator Light | ⑤ Knob               | ⑧ Speaker      | ⑪ Microphone        |
| ③ Function Key    | ⑥ Headset Interface  | ⑨ Headset Plug |                     |

## Operation

### 1. Power On/Off

**ON:** Press the On/Off Key for 2 seconds. When you hear voice prompt, the blue indicator flashes twice. The system enters the standby mode.

**OFF:** Press the On/Off Key for 2 seconds. When you hear voice prompt, the red indicator flashes twice.

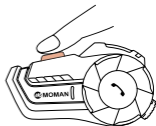

## 2. Pairing & Disconnection

### 2.1 with Two Intercoms

#### Pairing:

(1) Power on two intercoms and the blue indicators flash twice. The red and blue indicators flash alternatively, which means two intercoms wait to be Bluetooth paired.

(2) Then, press the On/Off Key of any one of them while the blue indicator flashes quickly with voice prompting "Intercom Search"; the red and blue indicator of the other keeps flashing alternatively. After few minutes, they are paired automatically with blue indicator flashing slowly.

#### Disconnect:

Press the Function Key for 2 seconds to disconnect the intercoms. Press it again to reconnect.

- ※ The distance between intercom and mobile phone should be within 1 meter.
- ※ When two intercoms are paired successfully, there is no need to pair them repeatedly. Under standby mode, they will be paired automatically after a few seconds.
- ※ The automatic connection function is available within five minutes after disconnection. If the connection fails again, you can manually press the Function Key once for searching and matching.

### 2.2 with Mobile Phone

(1) After power on, the blue indicator flashes twice. The red and blue indicator flashes alternatively, which means the intercom waits to be Bluetooth paired.

(2) Turn on the Bluetooth function of the mobile phone, search and select "MOMAN H2" to connect and pair. The voice will prompt "Bluetooth connected".

- ※ The distance between intercom and mobile phone should be within 1 meter.
- ※ If the intercom has pairing record with the mobile phone, they will be connected after power on, provided that the Bluetooth is turned on.

### 3. Phone Control

**Answer the call:** press the Function Key

**Automatic answer:** When the phone calls and there is no operation after 8 seconds, it will answer the call automatically.

**Reject the call:** press and hold the Function Key for 3 seconds until you hear the “beep” sound.

**End the call:** press the Function Key.

**Redial:** In standby mode, press the On/Off Key twice to dial the last call number.

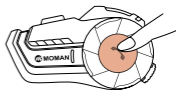

### 4. Music

(1) Under Bluetooth connection mode, press the Function Key to play/pause music.

(2) **Next Music:** turn the Knob counterclockwise.

(3) **Previous Music:** turn the Knob clockwise.

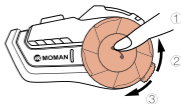

### 5. Volume Adjustment

(1) **Decrease:** continuously turn the Knob counterclockwise.

(2) **Increase:** continuously turn the Knob clockwise.

※ There is voice alarm for two high or two low volume.

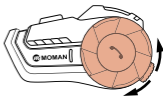

### 6. FM Radio

(1) **Turn on:** under standby mode, press the Function Key twice to switch to the FM radio.

(2) **Select Channels:** quickly rotate the Knob and release to adjust and select channels. Continuously rotate the Knob to select different channels. Rotate the Knob continuously to enter volume adjustment.

(3) **Turn off:** press the Function Key twice to get back

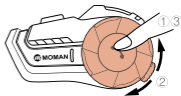

to the previous mode.

- ✳ If the signal is weak indoor, you could try to turn on the FM radio near window or in the open area.
- ✳ When FM radio is turned on and there is a phone calling, the machine will cut off FM radio automatically and connect to the mobile phone. It gets back to the FM radio when the call ends.

## 7. Multi-Mode Switch

### 7.1 Between Intercom and Music/FM Radio:

(1) In intercom mode, press the Function Key for 2 seconds and you hear “beep”, indicating the intercom mode exits, and enter the switch between Music/FM radio;

(2) **Turn on/off FM Radio:** Press the Function Key twice;

**Turn on/off Music:** short press the Function Key;

**Back to Intercom:** long press the Function Key.

### 7.2 Between Intercom and Mobile Phone:

(1) If the machine is connected with mobile phone, the intercom will disconnect when there is call. When the call ends, it will get back to the intercom mode, which takes 5 seconds.

### 7.3 Function Priority

Level 1: Mobile Phone

Level 2: Intercom

Level 3: Music/FM Radio

## 8. Language

When it is on, press On/Off Key and rotate the Knob to change the language of voice prompt.

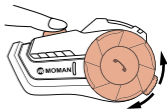

## Installation

### 1. Method 1: Install with Back Clip

- ① Use the screwdriver to loosen the screws of the back clip so that it can open to a proper extent.
- ② Open the helmet liner, insert the clip into the right position on the left side of the helmet and tighten the screw.
- ③ Slide the intercom into the back clip slot to make sure it locks firmly.
- ④ Open the helmet liner (ear position), clean the EPS surface of the helmet, and stick a piece of horn Velcro on the left and right sides of the helmet.
- ⑤ Stick the speaker on the fixed Velcro surface and the speaker with short line should be installed close to the machine. Fix the microphone and arrange the helmet lining and cable.
- ⑥ Insert the headset into the jack of the intercom and tie up the headset cable.

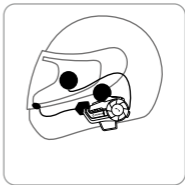
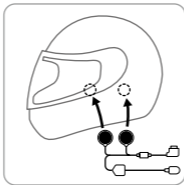
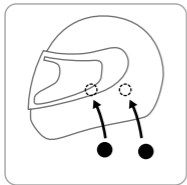
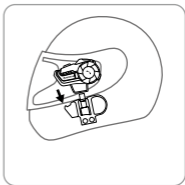
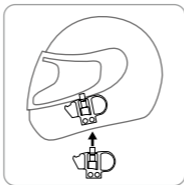
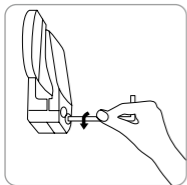

## Method 2: Install with Velcro Clip

Separate the hook and loop fasteners. First stick the hook onto the Velcro clip; choose the right installation position on the helmet and stick the loop to the position. Install the intercom onto the Velcro clip.

The installation of speakers can refer to the description above.

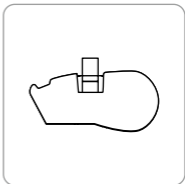
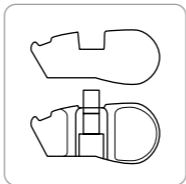
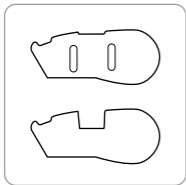



## 2. How to Remove the Intercom from Helmet

First unplug the headset, then press the fixed buckle in the middle of the back clip with one finger (push towards the side of the helmet), so that the back clip hook is detached from the intercom, and push the intercom upwards to let it slide out of the back clip smoothly to complete the disassembly.

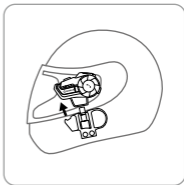
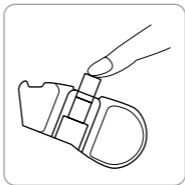
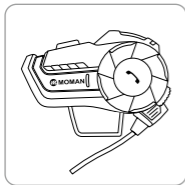

## 3. How to Fix the Headset Plug (If necessary)

Unscrew the screws on the back of intercom with screwdriver, open the buckle flap, plug in the headset plug and tighten the screws. If you need to plug out the headset, please open the buckle flap by unscrewing the screws.

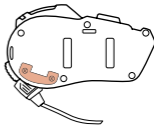

## Installation

1. Before using the Bluetooth intercom, please use the attached charging cable to charge the intercom. The small type-C interface on the charging line is connected to the USB charging interface of the Bluetooth intercom, and the large USB connector on the charging cable is connected to the following charging interface for power supply:

- A. USB interface of computer;
- B. A mobile power supply with DC 5V output;
- C. A USB power adapter with DC 5V output.

2. When charging, the red LED is always on, and when fully charged, the red light goes out slowly. It takes up to 2.5 hours to fully charge the unit.

## Specifications

Transmission Range	up to 800m
Connection Distance with Mobile	20m
Bluetooth Version	5.0
Bluetooth Protocol	A2DP, AVRCP
Charging Port	Type-C
Standby Time	300H
Working Time	20H
Battery	900mA
Charging Time	2H
Charging Voltage	5V
Speaker Diameter	40mm
Frequency Range	2.4GHz
Temperature Range	-20~50°C

## Notes

1. If you do not use intercom for up to one month or more, please charge the intercom once every two months in order to protect the lithium battery;
2. The storage temperature of this product is  $-20\text{ }^{\circ}\text{C}$  to  $50\text{ }^{\circ}\text{C}$  , and do not store in the environment with too high or low temperature, otherwise, the service life of the product will be affected;
3. Do not expose this product to fire to avoid explosion;
4. Only two screws on the back of intercom can be opened. Do not open other screws to the intercom to avoid short circuit of main board or battery damage.

## **Moman (UK) Limited**

---

 Unit 25 Basepoint Business Centre, Aviation Park, West Christchurch, United Kingdom BH23 6NX

 [www.momanx.com](http://www.momanx.com)

   @MomanGlobal

 <https://moman.co/youtube>